



**Collection:** SPHERIK

**Finish\*:**



00 - White

## Features

- **Dimensions:** 100 x 41
- **Material:** Ceramic
- **Faucet drilling:** 1 left faucet hole
- Generous, functional ledge
- One left tap hole: 4151K. One right tap hole: 1988W
- Chromed overflow cap
- **Weight:** 18.6 kg
- **Installation:** Self-supporting or can be mounted on a specific cabinet
- Fluidity between curved and straight lines
- Contemporary aesthetics with 1 slightly rounded centre basin
- Without overflow hole 4151K-X5

## Required products

- E78296: Click pop-up drain
- E78297: Design bottle trap 1 1/4" - short version

## Optional products

- E4131: Towel rail
- EB1008-G1C: Single-drawer cabinet 100 cm
- EB1009: single-drawer cabinet 100 cm
- EB1016-G1C: Single-drawer cabinet 100 cm
- EB1017: single-drawer cabinet 100 cm
- 3927K-R: Half side unit, right hinges, 96 cm
- 3927K-L: Half side unit, left hinges, 96 cm
- 3926K-R: Half side unit, right hinges, 96 cm
- 3926K-L: Half side unit, left hinges, 96 cm
- 3925D-R: Mirrored cabinet 98 cm, right hinges
- 3925D-L: Mirrored cabinet 98 cm, left hinges
- EB1161: Mirror 100 cm, with lighting and digital clock
- 98438D: Mirrored cabinet 100 cm
- 99379K: Tall column
- Formilia cabinet depth 36 cm

## Technical drawing

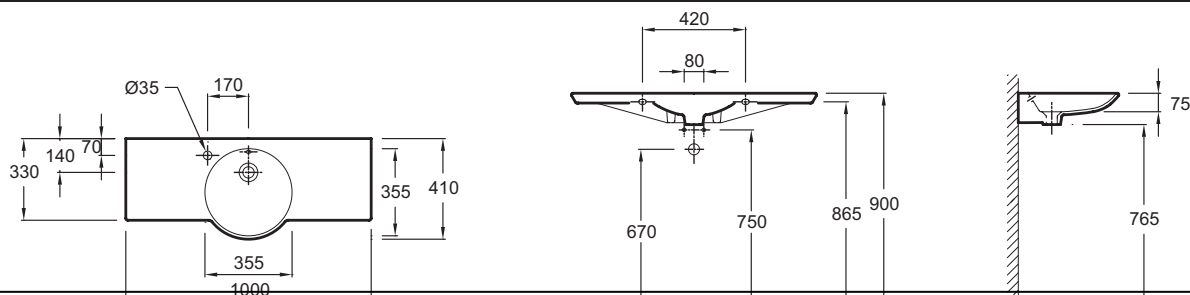

Product Specification: 1-hole vanity top 100 cm. 4151K. Collection: SPHERIK. Dimensions: 100 x 41. Weight: 18.6 kg. Material: Ceramic. Installation: Self-supporting or can be mounted on a specific cabinet. Faucet drilling: 1 left faucet hole. Fluidity between curved and straight lines. Generous, functional ledge. Contemporary aesthetics with 1 slightly rounded centre basin. One left tap hole: 4151K. One right tap hole: 1988W. Without overflow hole 4151K-X5. Chromed overflow cap.